

## Extension of a Uebel bass clarinet to low C

The essential parts of the new lower part with its new mechanics were initially designed in CAD. This ensures from the outset that the lever paths are correct and that nothing collides.

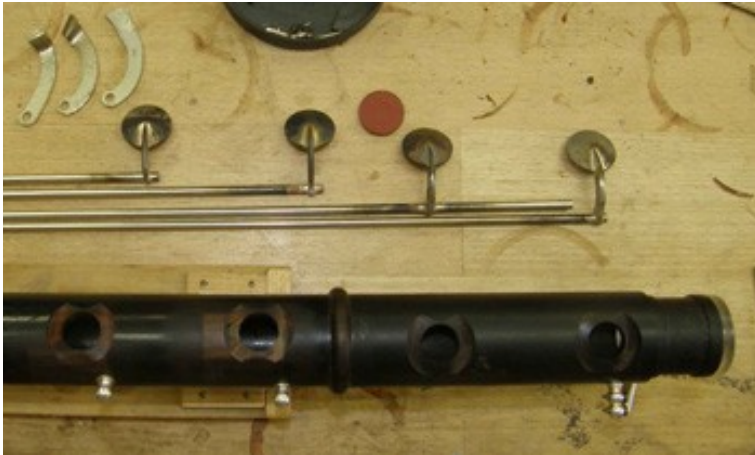
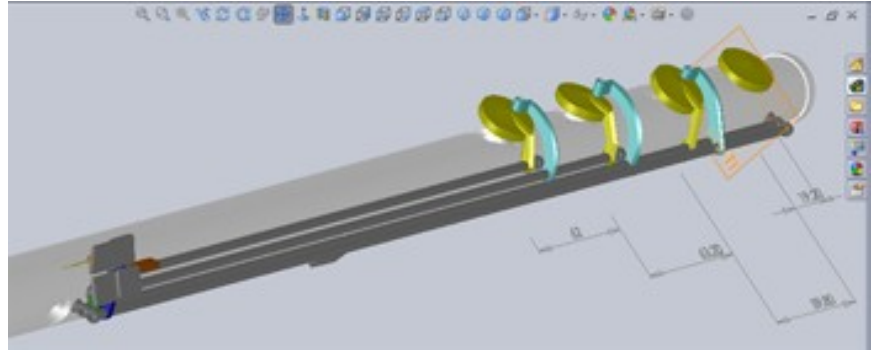

Now the old tone holes (E and Eb) as well as the old post drillings were closed. Then a grenadilla connection piece was made and set and the four new holes drilled to the correct acoustic position. We made the double posts from solid silver and gave the keys a new shape.

The finished instrument:

